

Butt Hinges	Should not exceed 5" (127 mm) in width
Auxiliary Stop	Recommended where a door cannot swing 140°
Reveal	Should not exceed 1/8" (3 mm)
Top Rail	<ul style="list-style-type: none"> Less than 3-1/2" (89 mm), requires PLATE 4510-18 Plate requires 2" (51mm) minimum top rail
Head Frame	Less than 1" (25 mm), consult factory
Clearance	2-1/4" (57 mm) behind door required for installation
Arm Clearance	Above door 1-1/8" (29 mm) required
Delay Action	<ul style="list-style-type: none"> Add suffix "DEL" to selected cylinder. Not available with 4516 cylinder. Delays closing from maximum opening to approximately 70°. Delay time adjustable up to approximately 1 minute.
Advanced Variable Backcheck	<ul style="list-style-type: none"> Cylinder starts backcheck at approximately 45° instead of the normal 75° Add suffix "AVB" to selected cylinder
Maximum opening	Can be templated for 140°: A = 4-3/16" (106 mm) B = 9-7/8" (251 mm)
Options	<ul style="list-style-type: none"> Delayed action or Advanced Variable Backcheck cylinder

Cylinder



4511(6)-3071
Cylinder Assembly

- Handed
- Cast iron
- Standard

Cover



4510-72MC
Metal Security Cover

- Handed
- Four point mounting for extra security
- Closer adjustments not accessible with cover installed
- Standard

Arms



4510-3077EDA
Extra Duty Arm

- Non-handed
- Solid forged steel main arm and forearm for potentially abusive installations
- Double slab arm/pinion attachment for maximum strength
- Standard

Installation Accessories



4510-18
Plate

- Required where top rail is less than 3-1/2" (89 mm)
- Requires minimum 2" (51 mm) top rail

How-to-order 4510 Series

Select cylinder size

- 4511 (adjustable from size 1 to 5)
- 4516 (DEL not available)

Select hand

- RH
- LH

Specify finish

- Standard Powder Coat _____
Aluminum, Dark Bronze, Statuary, Light Bronze, Black, Brass

Closer will be shipped with:

- Standard cylinder
- Security cover
- Extra duty arm
- TORX machine screw pack, unless options listed below are selected.

NOTE: Installation of this closer requires T-27 and T-25 driver bits for TORX machine screws with a security pin. Sold separately.

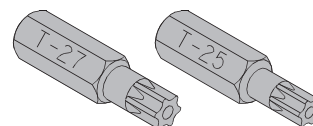

Closer options

Cylinder

- Delayed Action (DEL)
- Advanced Variable Backcheck (AVB)

Finishes

- Custom Powder Coat (RAL) _____
- Plated Finish, US _____
- SRI primer (use with powder coat finishes only)

Screw pack

- TB* and TORX Machine Screw (TBTRX)
*Specify door thickness if other than 1-3/4".

Installation accessories

- PLATE, 4510-18

Special template

- ST- _____

Table of sizes

- Select closer based on width of door
- The spring power of non-sized 4511 cylinder is adjustable from size 1 through size 5 and is shipped set to size 3
- Sized 4510 Series cylinder available in size 6
- Delayed action not available with 4516 cylinder

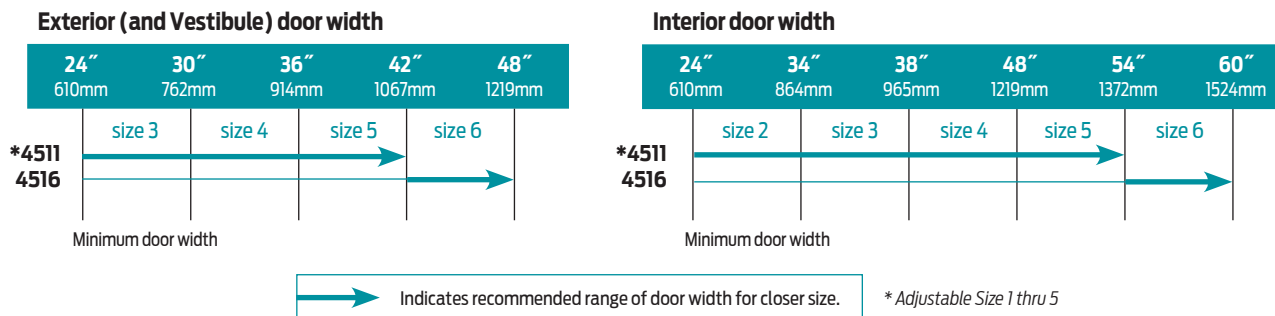

Reduced opening force 4510 Series closers

CAUTION! Any manual door closer, including those certified by BHMA to conform to ANSI Standard A156.4, that is selected, installed and adjusted based on ADA or other reduced opening force requirements may not provide sufficient power to reliably close and latch a door.

Refer to POWER OPERATORS section for information on systems that meet reduced opening force requirements without affecting closing power.

* Maximum opening force.

	DOOR WIDTH	36"	42"	48"
	8.5* lbs.	4511	4511	4511
5.0* lbs.	4511	4511	4511	

* Maximum opening force.